



STEEL+ STORE

Materials in Top Form

Storage and Delivery Programme

EVERY QUALITY PRODUCT STARTS WITH THE OPTIMAL MATERIAL. WE FIND IT AND DELIVER IT TO YOU.

Interactive Portfolio

We are service oriented and innovative. That shows our interactive storage and delivery program which makes every search easy.

Our company

As one of the largest family-run integrated trading and production companies within the steel and metal industry in Germany, the **Heine+Beisswenger Group** traditionally stands for an optimally coordinated, broad range storage and delivery program.

All over Germany

We are producer-independent, stockkeeping, and offer you a **nationwide** branch network contacts for each region. Our wide range of steels, stainless steels and non-ferrous metals is continuous expanded to include new materials and is based on the future market requirements.

With the widest spectrum

We make sure that our range is tailored to the customer needs and are constantly expanding the portfolio in terms of material, dimensions, and alloys. You don't see the material, the dimension or the alloy you want? **Our core competence is to find the right material and to deliver it to you.**

Click on

for more details.





[Our origins are in retail](#)

But our strength today goes far beyond the topic of materials: **We remain at your side** as a strong partner throughout the entire value chain. We therefore also support you with numerous services in the areas of processing and logistics.

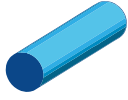
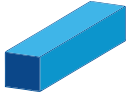
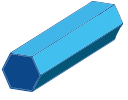
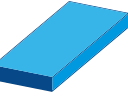
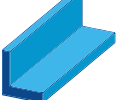
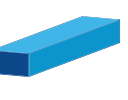
Quality/Form RAL-Color	Material No.						
S235JRC	1.0037	•	•	•	•	•	•
S355J2C	1.0570	•	•	•	•		
C15	1.0401	•					
C35 *	1.0501	•		•			
C45	1.0503	•	•	•	•		•
11SMn30	1.0715	•	•	•			
11SMnPb30	1.0718	•	•	•			
11SMnPb30+Te/+ Bi*	1.0719	•					
35S20	1.0726	•		•			
46S20	1.0727	•		•			
44SMn28 *	1.0762	•					
44SMn28+C+SR *	1.0762	•					
C15Pb *	1.0403	•					
C35Pb *	1.0502	•		•			
C45Pb	1.0504	•		•			
115CrV3	1.2210	•					
42CrMoS4+A	1.7227	•		•			
42CrMoS4+QT	1.7227	•		•			
16MnCrS5(+FP)	1.7139	•		•			
16MnCrPb5(+FP)	1.7142	•		•			
100Cr6+AC	1.3505	•					

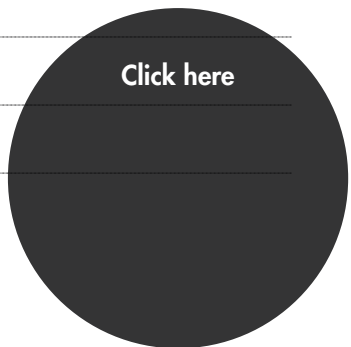

* Other qualities, forms and dimensions on request.

• Manufactured using conventional processes • CO₂ reduced available

[BRIGHT STEEL] Details

Round

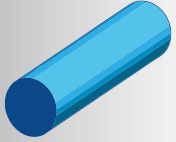

Unalloyed bright round steel, +C or +SH, EN 10277 / 10278, tolerance zone h9 / h11

Unalloyed bright round steel + SL, EN 10277 / 10278, tolerance zone h6

Bright cutting steel, round +C / +SH, EN 10277 / 10278, tolerance zone h9 / h1

Bright round steel, alloyed to better chipping +C or +SH, EN 10277 / 10278, tolerance zone h9 / h11

Round steel, (silver steel) 115CrV3, +C / +SH, DIN 175, sanded and polished, annealed

Stainless steel round, bright +C / +SH, EN 10277 / 10278, tolerance zone h9 / h11

from 3 to 180 mm	from 6 to 120 mm	from 2 to 190 mm	from 5 to 60 mm	from 4 to 40 mm	from 5 to 110 mm
S235JRC	C45	11SMn30	C15Pb *	115CrV3	42CrMoS4+A
S355J2C		11SMnPb30	C35Pb *		42CrMoS4+QT
C15		11SMnPb30+Te/Bi *	C45Pb		16MnCrS5
C35		35S20			16MnCrS5+FP
C45		46S20			16MnCrSPb5+FP
		44Mn28 *			100Cr6+AC
		44SMn28+C+SR *			

Hexagonal

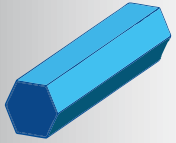

Unalloyed bright hexagon steel, +C, EN 10277 / 10278, tolerance zone h11

Bright free cutting steel, hexagon, +C, EN 10277 / 10278, tolerance zone h11

Stainless steel hexagon, pulled blank +C, EN 10277 / 10278, tolerance zone h11

from 10 to 75 mm	from 5 to 75 mm	from 13 to 55 mm
S235JRC	11SMn30	42CrMoS4+A
C35	11SMnPb30	42CrMoS4+QT
C45	35S20 *	
C35Pb	46S20 *	
C45Pb		
S355J2C		

Square

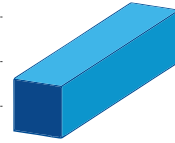

Unalloyed bright square steel, +C, EN 10277 / 10278, tolerance zone h11

Bright free cutting steel, square +C, EN 10277 / 10278, tolerance zone h11

from 4 to 120mm	from 5 to 100 mm
S235JRC	11SMn30
C45	11SMnPb30
S355J2C	

Flat

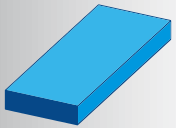

Unalloyed bright flat steel, +C, EN 10277 / 10278, tolerance zone h11

from 6x3 to 400x30 mm
S235JRC
C45
S355J2C

Wedge

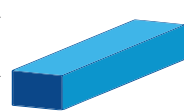

Bright key steel, EN10277 bright + C, DIN 6880

from 8x5 to 40x22mm
C45

Angle

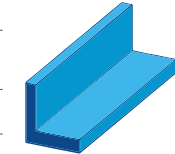

Bright, sharp-edged drawn Angle steel, DIN 59370

from 10x10x2 to 100x100x10 mm
S235JRC



FOR WIDESPREAD USE IN THE MAIN INDUSTRIAL SECTORS - OUR UNALLOYED STEELS.



- * Other qualities, forms and dimensions on request.
- Manufactured using conventional processes • CO₂ reduced available

[HIGH-GRADE STEEL]

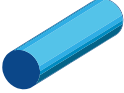
Overview

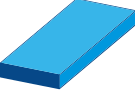
Quality/Form RAL-Color	Material No.			
C45	1.0503	●		
S355J2	1.0577	●		
100Cr6+AC	1.3505	●		
16/20MnCr(S)5	1.7139	●		
18CrNiMo7-6+A	1.6587	●		
31CrMoV9+QT*	1.8519	●		
34CrAlNi7-10+QT+SR*	1.8550	●		
42CrMo(S)4+QT	1.7227	●		
42CrMo(S)4+A	1.7227	● ●		
51CrV4+QT*	1.8159	●		
30CrNiMo8+QT	1.6580	●		
34CrNiMo6+QT	1.6582	●		
42CrMo4+QT*	1.7225		●	●
16MnCr5	1.7131		●	●

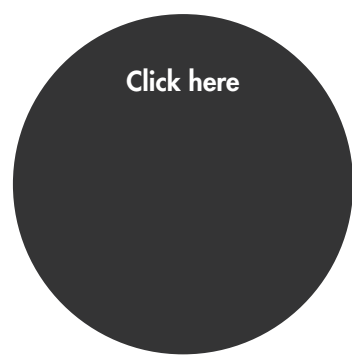

* Other qualities, forms and dimensions on request.
 ● Manufactured using conventional processes ● **CO₂ reduced available**

HIGH-GRADE STEEL

Details

Round

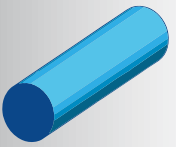

Round steel, rolled, EN 10060	Round steel, forged, EN 10250-2	Bearing steel, rolled, EN 10060 or forged DIN 7225	Case-hardened steel, rolled, EN 10060 or forged DIN 7225	Nitrided steel, rolled, EN 10060 or forged DIN 7225
from 20 to 300 mm	from 300 to 540 mm	from 40 to 280 mm	from 20 to 240 mm	from 20 to 100 mm
C45	C45E+N	100Cr6+AC	16MnCrS5 H5Q	4CrAlNi7-10+QT+SR
S355	S355J2G3+N		from 20 to 410 mm	from 20 to 320 mm
16/20MnCrS5	42CrMoS4+QT		18CrNiMo7-6+A	31CrMoV9+QT
42CrMoS4+QT	16/20MnCrS5+FP		16MnCr(S)5	

Square

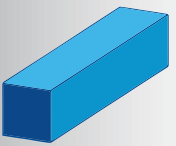

Stainless steel, square rolled, EN 10059

from 20 to 150 mm

42CrMo4+QT *

16MnCr5

Flat

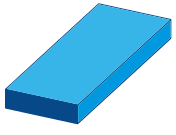

High-grade flat steel, rolled, EN 10058

from 20x10 to 200x20 mm

42CrMo4+QT *

16MnCr5

UNALLOYED STEELS ARE AVAILABLE FROM US IN ROLLED CONDITION, BUT ALSO AS BRIGHT MATERIALS IN DRAWN, PEELED AND GROUND VERSIONS.

- * Other qualities, forms and dimensions on request.
- Manufactured using conventional processes • **CO₂ reduced available**



STAINLESS STEEL

Overview

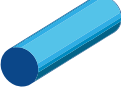
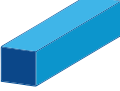
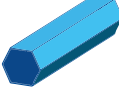
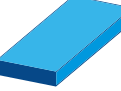
Quality/Form RAL-Color				
1.4021+QT	•			
1.4034+A	•			
1.4057+QT	•			
1.4104+A/+QT	•		•	
1.4112 + A	•			
1.4122	•			
14301/1.4307	•	•	•	•
1.4305	•	•	•	•
1.4404	•		•	
1.4462	•			
1.4541	•			
1.4571	•		•	



* Other qualities, forms and dimensions on request.
 • Manufactured using conventional processes • **CO₂ reduced available**

STAINLESS STEEL Details

Round

Stainless steel, round, +C / +SL / +SH, EN 10278 / h8 or h9

Stainless steel, round, rolled after EN 10060 or overwound / peeled

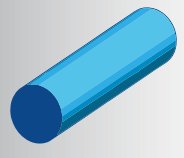

from 2 to 100 mm	from 22 to 200 mm
1.4021 + QT	1.4021 + QT
1.4034 + A	1.4301/1.4307
1.4057 + QT	1.4305
1.4122 + A	1.4404
1.4301 / 1.4307	1.4571
1.4305	
1.4404	
1.4462	
1.4541	
1.4571	

Sechskant

Stainless steel, hexagon, EN 10278 / h11

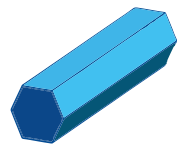

from 4 to 65 mm
1.4104 + A
1.4301 / 1.4307
1.4305
1.4404
1.4571

Square

Stainless steel, square, EN 10278 / h11

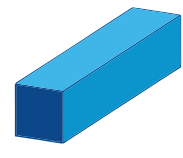

from 4 to 50 mm
1.4305
1.4301 / 1.4307

Flat

Stainless steel, flat, EN 10278 / h11

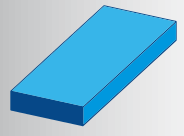

from 4 to 50 mm
1.4305
1.4301 / 1.4307

STAINLESS STEELS ARE STEEL GRADES WITH A HIGH DEGREE OF PURITY. A HIGH PROPORTION OF CHROMIUM AND NICKEL IN THE ALLOY MAKES THEM RESISTANT TO MEDIA SUCH AS WATER, SALT WATER, ACIDS AND ALKALIS.

- * Other qualities, forms and dimensions on request.
- Manufactured using conventional processes • **CO₂ reduced available**

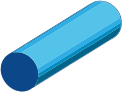
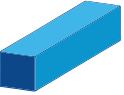
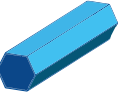
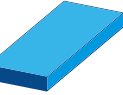
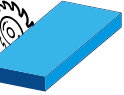

ALUMINUM Overview

Quality/Form RAL-Color	Material No.					
AlCu4PbMgMn	EN AW 2007	•	•	•	•	
AlCu6BiPb	EN AW 2011	•	•	•		
AlCu4MgSi	EN AW-2017A					•
AlCu2,5BiMnMg	EN AW-2033	•				
AlMg3	EN AW-5754					•
AlMg4,5Mn0,7	EN AW-5083					•
AlMgSiBi	EN AW-6026LF	•		•		
AlSi1MgMn	EN AW-6082	•		•	•	•
AlZn5,5MgCu	EN AW-7075	•				•



* Other qualities, forms and dimensions on request.

• Manufactured using conventional processes • **CO₂ reduced available**

ALUMINUM Details

Round

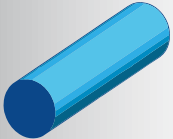

Aluminum round bars, EN 573-3, EN 754-1/2/3, drawn, chamfered at least on one side, HL 3.000mm, Tol. -0/+50mm, Tol. h9 up to and including 25mm rd, with inspection certificate according to EN 10204/3.1

from 6 to 65 mm

EN AW-2007

EN AW-2011

EN AW-6082

EN AW-7075

Aluminum rods, EN 573-3, EN 754-1/2/3, up to 65mm one-sided chamfered, from 70mm on both sides sawn, Tol. h9 up to and including 25mm rd, RoHS compliant

from 6 to 65 mm

EN AW-2033

EN AW-6026 LF

Aluminum round bars, EN 573-3, EN755-1/2/3, sawn on both sides, RoHS compliant

from 70 to 240 mm

EN AW-6026LF

EN AW-6082

EN AW-7075

Aluminum round bars, EN 573-3, EN755-1/2/3 pressed, HL 3.000 mm, tol. +/- 100 mm, both sides sawn, bundles à 500 kg, with inspection certificate according to EN 10204/3.1

from 20 to 250 mm

EN AW-2007

EN AW-2011

Hexagonal

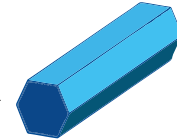

Aluminum hexagonal bars, EN 573 / 754, drawn in lengths of approx. 3 m

from 10 to 36 mm

EN AW-6026LF

EN AW-6082

Square

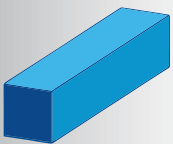

Drawn aluminum square bars, EN 573 / 754, in lengths of approx. 3 m

from 15 to 36 mm

EN AW-2007

EN AW-2011

Pressed aluminum square bars, EN 573 / 755, in lengths of approx. 3 m

from 30 to 160 mm

EN AW-2007

EN AW-2011

Pressed aluminum square bars, EN 573 / 755, in lengths of approx. 3 m

from 25 to 140 mm

EN AW-6082

Plate

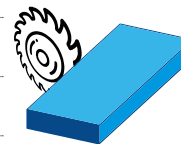

Precision plates/-cuts of aluminum face-milled and foiled on both sides, thickness tolerance +/- 0.1 mm sawing tolerances: +/- 0.3 mm

Thickness from 5 to 60 mm

EN AW 5083 gewalzt

EN AW 5083 gegossen

EN AW 7075 gewalzt

Plates / plate cuts made of aluminum low-tension stretched according to EN 4851-4, EN 573-3. Saw tolerances: +/- 0.3 mm

Thickness from 5 to 200 mm

EN AW-2017A

EN AW-5083

EN AW-5754

EN AW-6082

EN AW-7075

Flat

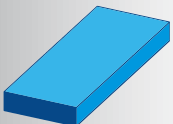

Pressed flat bars out Aluminum, EN 573 / 755, in lengths of approx. 3 m

from 20x10 to 120x50 mm

EN AW-6082

OUR MATERIAL FOR THE FUTURE: WITH THE POSSIBILITY OF ADAPTATION THROUGH ALLOYING AND ADDITIONAL ELEMENTS, ALUMINUM IS THE BEST BASIS FOR MANY INNOVATIVE DEVELOPMENTS AND PRODUCTS.

- * Other qualities, forms and dimensions on request.
- Manufactured using conventional processes • **CO₂ reduced available**

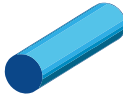
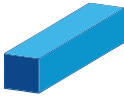
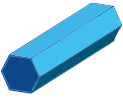

BRASS Overview

Quality/Form RAL-Color	Material No.	  
CuZn42*	CW510L	•
CuZn38As*	CW511L	•
CuZn39Pb3	CW614N	• • •
CuZn40Pb2	CW617N	•
CuZn21Si3P*	CW724R	•



* Other qualities, forms and dimensions on request.
 • Manufactured using conventional processes • **CO₂ reduced available**

BRASS Details

Round

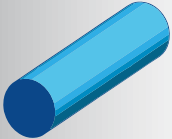

Round rods
Made of brass
CuZn39Pb3,
(CW 614 N)
EN 12164 /
EN 12165
CuZn40Pb2,
(CW 617 R)
EN 12164 / Hans
Grohe Norm /
Drinking Water
Ordinance

von bis 3,0 bis
110 mm

CuZn39Pb3

CuZn40Pb2

Round rods
Brass max. 0.1%
Pb

von bis 10,0 bis
60 mm

CuZn42 (CW510L)*

CuZn38As
(CW511L)*

CuZn21Si3P
(CW724R)*

Square

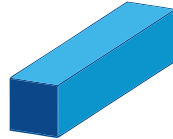

Square bars
made of brass
CuZn39Pb3,
(CW 614 N)
EN 12164

von 4 bis 50 mm

CuZn39Pb3

Hexagonal

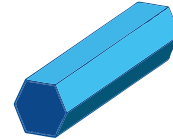

Hexagonal rods
made of brass
CuZn39Pb3,
(CW 614 N)
EN 12164

von 4,5 bis 70 mm

CuZn39Pb3

COPPER AND ZINC IN PERFECT BALANCE.

- * Other qualities, forms and dimensions on request.
- Manufactured using conventional processes • CO₂ reduced available



PISTON RODS Overview



Quality/Form
RAL-Color

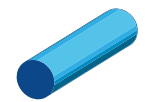

C45E	•
C45E+QT	•
42CrMo4	•
42CrMo4+QT	•
20MnV6	•

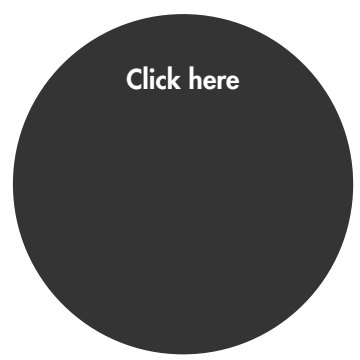

- * Other qualities, forms and dimensions on request.
- Manufactured using conventional processes • **CO₂ reduced available**

PISTON RODS Details

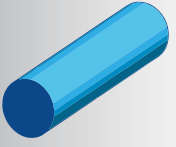

Round, hard chrome plated EN 683-1 Round, hard chrome plated EN 10278 Round, hard chrome plated (ICB), hardened, EN 683-1 Round, tempered, hard chrome plated, (CBC), EN 683-2

from 6 to 25 mm	from 26 to 130 mm	from 30 to 100 mm	from 30 to 50 mm
C45E	C45E	C45E+QT	42CrMo4
Round, tempered, induction hardened, hard chrome plated (ICBC) EN 683-2	Round, hard chrome plated, (CBA), EN 10267	Round, hard chrome plated, (CBA), EN 10277	
from 40 to 100 mm	from 20 to 70 mm	from 80 to 130 mm	
42CrMo4+QT	20MnV6	20MnV6	

ENSURING BETTER RESISTANCE WITH A CHROME OR CHROME/NICKEL COATING AND SERVING AS A SEALING SURFACE BETWEEN THE POWER OPERATED AREA OF THE CYLINDER AND THE EXTERNAL ENVIRONMENT.

- * Other qualities, forms and dimensions on request.
- Manufactured using conventional processes • **CO₂ reduced available**





GREEN LINE

STEEL AT ITS BEST:
NOW ALSO GREEN.



Important Partner

As a steel and metal trading company, we are an important partner both for the manufacturing plants and for customers in the automotive, mechanical engineering, renewable energy, agricultural, food, etc. sectors. Synergies between manufacturers, traders and customers enable us to make faster progress on the road to green steel.

CO₂ reduced available

Customer requirements and expectations with regard to product carbon footprint data are increasingly being demanded in concrete terms, which is why we also offer our customers **CO₂ reduced steel**. Marking with •, other grades and designs on request.



Quality/Form RAL-Color	10 - 32 mm	10 - 36 mm	10 - 38 mm	10 - 40 mm	10 - 42 mm
16MnCrS5					●
16MnCr5 (DBL4027)					●
16MnCrS5Pb					●
20MnCrS5					●
11SMn30					●
11SMnPb30					●
C15					●
C35				●	
C45			●		
36SMnPb14				●	
20MnB5 / 20MnB4					●
44SMn28		●			
46S20			●		
46S20Pb			●		
35S20			●		
C15Pb					●
C35Pb				●	
C45Pb			●		
S355JR / ST52					●
S235					●

* Other qualities, forms and dimensions on request.

● Manufactured using conventional processes ● **CO₂ reduced available**

Quality/Form RAL-Color	10 - 32 mm	10 - 36 mm	10 - 38 mm	10 - 40 mm	10 - 42 mm
42CrMoS4 (+A+C)	●				
41CrS4 (+A+C)	●				
34Cr4 (+A+C)				●	
34CrMo4 (+A+C)				●	
51CrV4 (+A+C)	●				

* Other qualities, forms and dimensions on request.

● Manufactured using conventional processes • **CO₂ reduced available**



FIND OUT MORE



TO THE FUTURE



Locations of the Heine + Beisswenger Group:

D-70736 FELLBACH

D-78647 TROSSINGEN

D-75181 PFORZHEIM

D-64807 DIEBURG

D-90579 LANGENZENN

D-84094 ELSENDORF

D-07629 HERMSDORF (Heine & Bleck)

Subsidiaries:

Otto Prawitt GmbH & Co. KG,

D-42553 Velbert und D-58840 Plettenberg

H+B Hightech GmbH, D-73486 Adelmansfelden

ROTEC GmbH, D-89568 Hermaringen

HEINE + BEISSWENGER STIFTUNG + CO. KG

Höhenstraße 22 · 70736 Fellbach · Mail: info@heine-beisswenger.de

Tel.: +49 711 5854-0 · Fax: +49 711 5854-239